

THE PLACE TO MEET...

WELCOME TO THE NEW CROWNE PLAZA ATLANTA MIDTOWN!

You'll find an exceptional combination of deluxe accommodations and an endless list of amenities – all designed to make your stay an unforgettable experience. Strategically located between Downtown and Buckhead – right in the heart of the city's most trendsetting neighborhood – it's the perfect environment for everything from a productive business meeting to a relaxing weekend getaway. Read on and see all that we have to offer.

GETTING AROUND

Want to get somewhere fast? The Metropolitan Atlanta Rapid Transit Authority, or MARTA, is just steps away from the Crowne Plaza Atlanta Midtown. The highway is also seconds away and gives you convenient access to Downtown or the airport. For questions regarding MARTA, contact your Service Agent in the Crowne Plaza Lobby.

HOSTING

Let the Crowne Plaza Atlanta Midtown host your next business meeting, convention or special event. We offer meeting and banquet spaces that are flexible enough to meet all of your special needs. Additionally, you can choose to hold your event in our signature 25th floor event space featuring breathtaking, panoramic views. Just imagine the possibilities.

Here is just a glimpse of what we offer:

- 31,000 Sq. Ft. of Newly Renovated Flexible Meeting Space
- Exclusive 'SKY' Panoramic Event Space
- 360 Guest Rooms & Suites
- 'FIRST' Breakfast Restaurant
- 'NEXT' Lobby Bar - Great for all Size Groups
- 'THRIVE' Coffee Shop
- Roof Top Pool Accessible from the 4th Floor
- Fitness Center
- Business Center / Copying & Printing
- Valet and Self-Parking (Fees Apply)
- Complimentary Wireless Internet Access

SITES & ATTRACTIONS

Take in all of our hospitable Southern charm while you explore cultural attractions, top institutions of higher learning, historic sites and much more. There is so much to experience! The best place to be is at the Crowne Plaza Atlanta Midtown, the center of it all.

Here are a few ideas to get you started:

- Centennial Olympic Park
- Georgia Aquarium
- Fox Theatre
- High Museum of Art
- Georgia World Congress Center
- Georgia Dome
- College Football Hall of Fame
- Atlanta Symphony Orchestra
- Georgia Institute of Technology
- Atlantic Station
- Piedmont Park
- CNN Center
- Atlanta Botanical Gardens
- Center for Civil & Human Rights
- World of Coca-Cola Museum

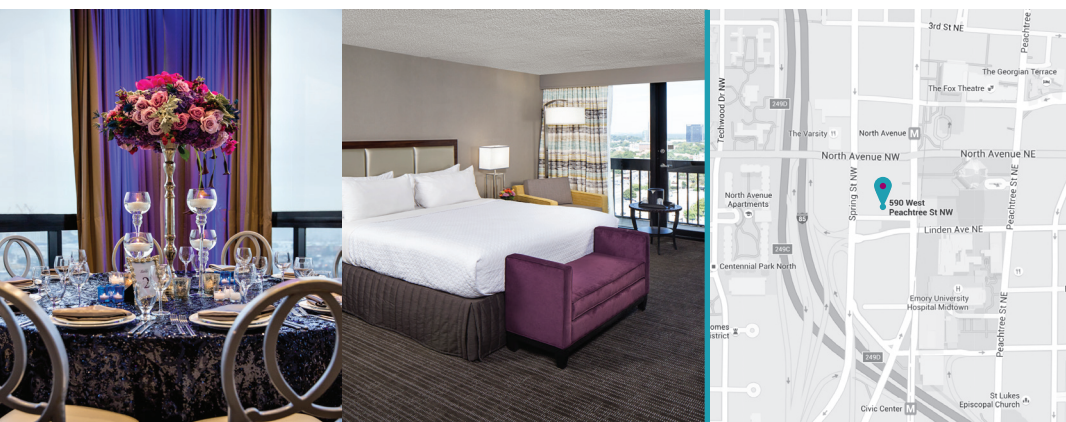

ATLANTA HARTSFIELD INTL AIRPORT (ATL)

11 Miles NORTH to Hotel. Follow signs for I-85 North. Take exit 249D for Spring St. toward US-19 / US-29W Peachtree Street. Slight left at Linden Ave NW. Turn left at West Peachtree St. NW. The hotel will be on your left.

SUBWAY

Train Charge (one way): \$2.50 + \$1 Card Charge
Subway Station Name: North Ave MARTA Station
Exit on West Peachtree, Take a Left. The hotel will be on your right hand side.

MEETINGS & BANQUETS

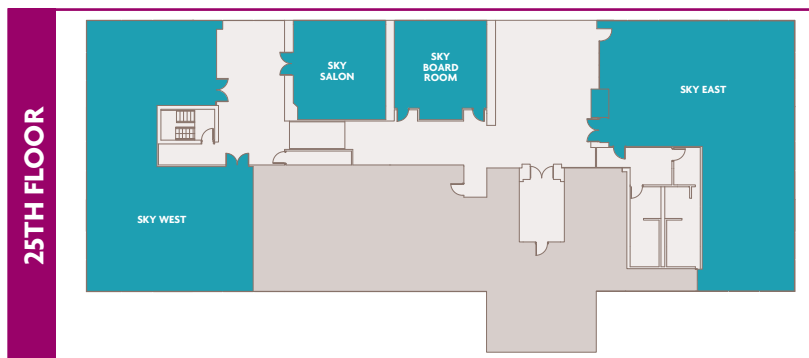
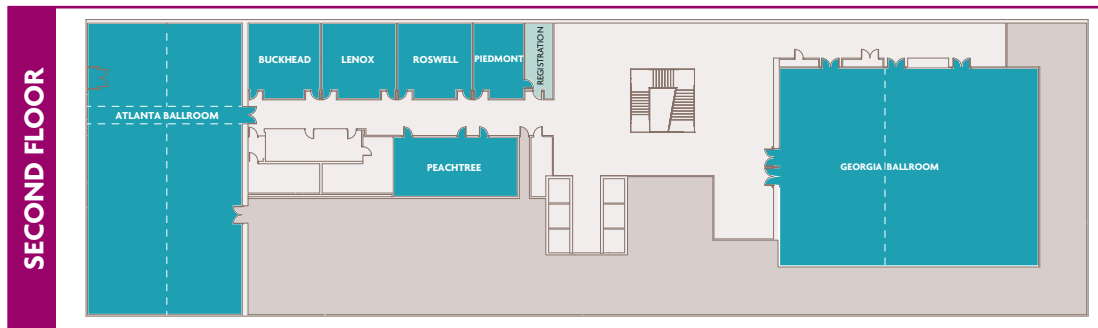

MEETING ROOM MEASUREMENTS & CAPACITIES

MEETING ROOMS	SQ. FT.	CEILING HEIGHT	DIMENSIONS	COCKTAIL	THEATRE	CLASSROOM	BANQUET	U SHAPE	CONFERENCE
LOBBY LEVEL									
APARTMENT	285	10	12 x 23	—	—	—	—	—	6
SALON	1,763	9	41 x 43	250	200	100	120	50	40
PRIVATE DINING ROOM	1,170	9	26 x 45	110	—	—	70	38	40
SECOND FLOOR									
GEORGIA BALLROOM	5,916	16	68 x 87	700	600	350	400	100	70
GEORGIA WEST	2,244	16	33 x 68	200	265	112	150	60	50
GEORGIA EAST	3,672	16	54 x 68	500	335	200	250	70	50
G.B. PRE-FUNCTION	3,692	—	—	—	—	—	—	—	—
ATLANTA BALLROOM	4,628	12	49 x 94	550	300	200	300	100	70
ATLANTA A	1,196	12	23 x 52	125	150	80	80	40	44
ATLANTA B	1,560	12	30 x 52	150	150	80	100	50	44
ATLANTA C	598	12	23 x 26	50	65	24	40	20	22
ATLANTA D	780	12	30 x 26	60	70	28	50	25	22
PIEDMONT	438	9	17 x 27	25	25	12	20	15	16
ROSWELL	665	9	26 x 28	50	70	24	40	25	22
PEACHTREE	877	9	20 x 43	75	90	52	60	30	36
LENOX	660	9	25 x 27	60	70	28	40	24	22
BUCKHEAD	650	9	25 x 28	60	70	28	40	24	22
25TH FLOOR									
SKY BOARDROOM	573	12	24 x 25	—	—	—	—	—	12
SKY WEST	2,378	13	43 x 70	150	180	60	140	40	60
SKY EAST	2,470	13	48 x 70	150	200	80	170	60	60
SKY SALON	600	10	25 x 25	40	30	24	40	22	20